

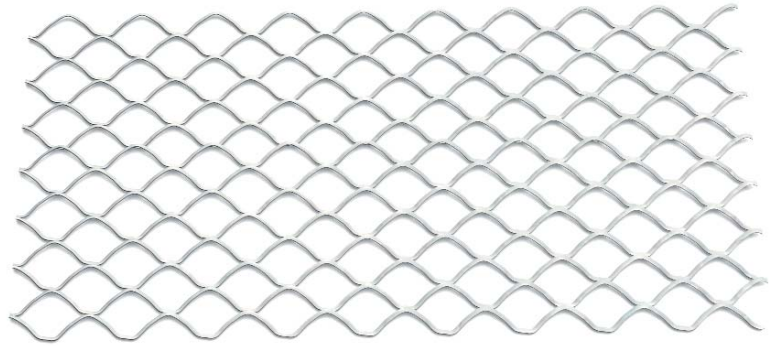

Expanded metal strip for general plaster reinforcement.

- Finished edges for safe handling.
- Galvanized for corrosion protection.
- Easy to apply and finish.



Strip Lath

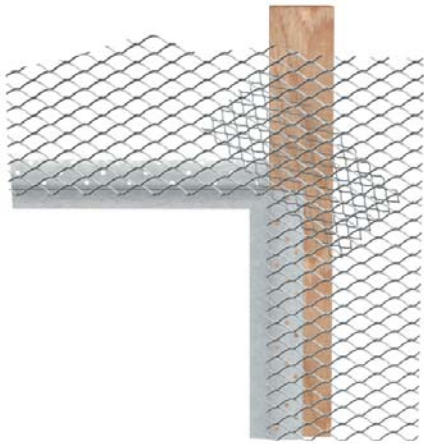

Dietrich Strip Lath is a flat expanded metal strip used as plaster reinforcement over joints of non-metallic lathing bases and where dissimilar bases join. It's commonly attached diagonally at the corners of doors, windows or areas prone to cracks. It may also be used to span pipe chases or reinforce other stress points such as the corners of openings in the stucco membrane within the lath system. Available in 4" and 6" widths and 8' lengths.



Strip Lath (LAST)

DMF Product Code	Size				Weight/Carton		Packaging	
	Width		Length		lbs	kg	Pcs/Bundle	Pcs/Skid
	Inches	mm	ft	m				
LAST	4	102	8	2.44	24.5	11.1	75	1350
	6	152	8	2.44	35.8	16.2	75	1350