

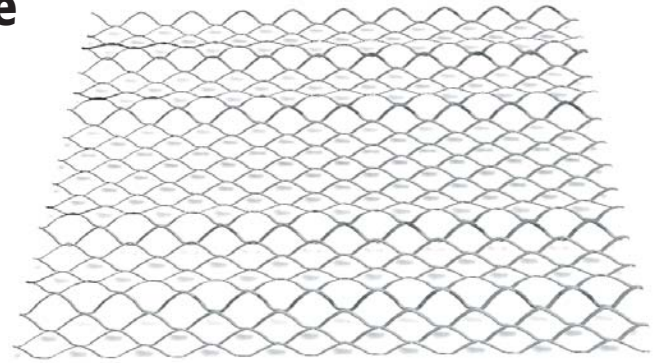

V-Groove raises lath substrate for strong mechanical bond over solid surfaces.

- *V-Grooves provide space for full plaster key into mesh.*
- *Maintains consistent plaster depths.*
- *Eliminates need for added furring strips.*
- *Available in 1.75, 2.5 and 3.4 lbs. per square yard.*



Self-Furring, V-Groove

Dietrich self-furring v-groove mesh lath is manufactured with five approximately 1/4" deep "v" ribs along the length of the sheet. These Vs raise the diamond mesh from solid surfaces to allow thorough plaster or stucco penetration into and behind the lath for superior mechanical bonding. V-Groove is used over solid surfaces like concrete, cement board, column fireproofing, masonry, sheathing and replastering over old surfaces. To maintain the designed V-groove furring characteristics, fasteners must be applied within the V-cavity.

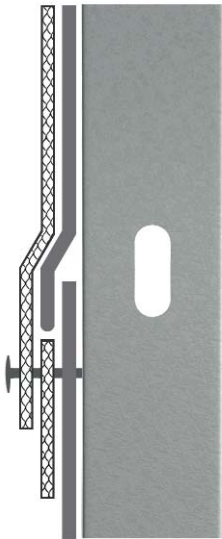
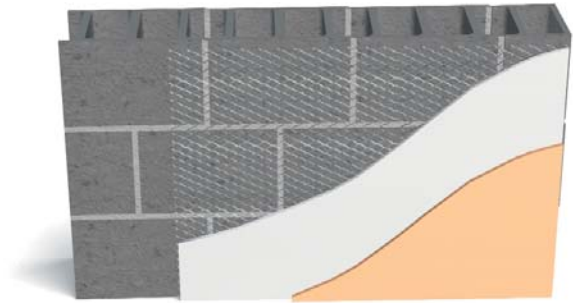

V-Groove is also available with asphalt paper-backed for applications that require a moisture barrier. The glue-attached asphalt-saturated paper also ensures a consistent plaster or stucco depth as the paper prevents excessive plaster waste. Care should be taken to make sure paper overlaps paper in a shingle-like manner during application.

Paper-Backed Offset Options

- P** — Paper is offset by 1" on one side and one end. +
- O** — Paper is offset by 2" on one side and one end.

+ Available for non-code work. The International Building Code (IBC) requires a 2" paper lap per ASTM C 1063-06.



Self-Furring V-Groove Mesh Lath (LAV), (P), (O)

DMF Product Code	Weight		Size				Packaging			
	lbs./yard ²	kg/m ²	Width		Length		Pcs/Bundle	Bundles/Skid	Yards ² /Skid	m ² /Skid
			Inches	mm	Inches	mm				
LAV (P, O)	1.75	1.0	27	686	96	2438	10	25	500	418
	2.5	1.4	27	686	96	2438	10	25	500	418
	3.4	1.8	27	686	96	2438	10	25	500	418